

Přední kola

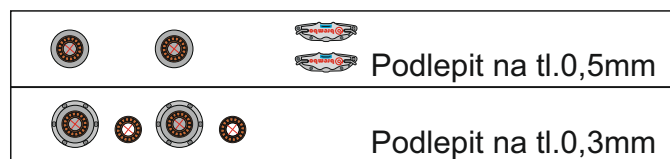

Zadní kola

1 : 24

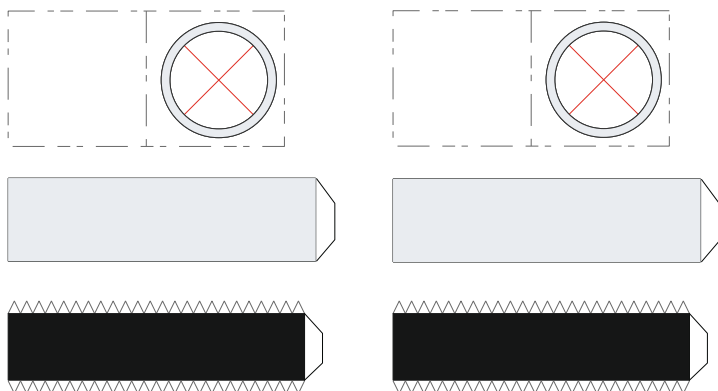

Brzdové třmeny
použitelné u
jiného vozu

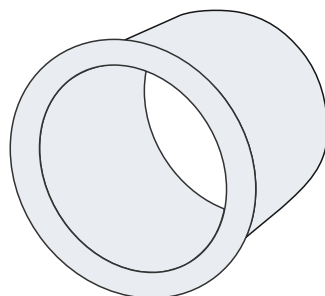

Vnitřní disk slepený
ze šedivých dílů, za-
sunutý do slepeného
kola.

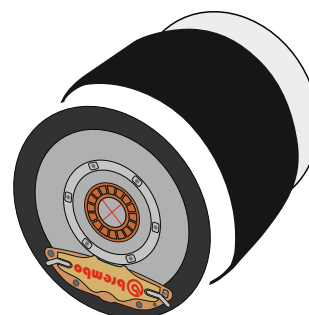

Imitace brzdy, slepená
z černých dílů, brzdového
třmeny a koleček náboje
podlepených na doporu-
čenou tloušťku.

Imitace brzdy přijde nalepit na nápravy v požadované poloze napevno. Imitací bude prostrčena osa, která bude mít na konci sbroušenou špičku montážní matice. Vnitřní disk bude vlepen do hotového kola. Kolo se nasune na náboj brzdy tak, aby z vnějšího disku vyčnívala osa zhruba tak 2,5mm ven z kola. Kola jdou na brzdový náboj nasunout těsněji. Foto postup lze najít na adrese:

<http://cashpick.cz/forum/viewtopic.php?t=1468&postdays=0&postorder=asc&start=15>

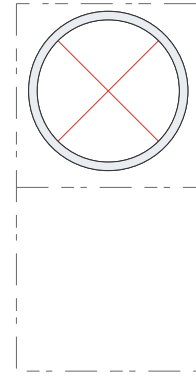
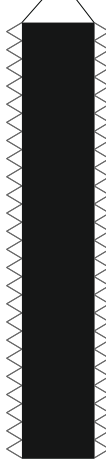
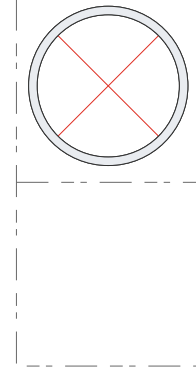

Podlepit na tl.0,5mm

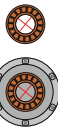
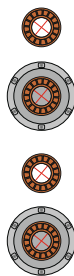

Podlepit na tl.0,3mm

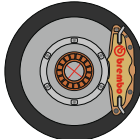
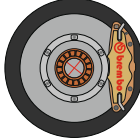

1 : 18

Přední kola

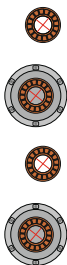
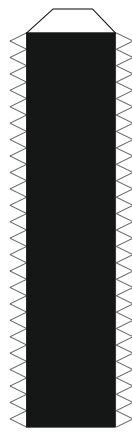
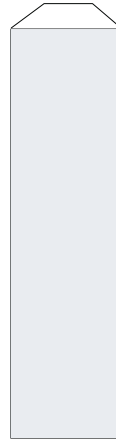
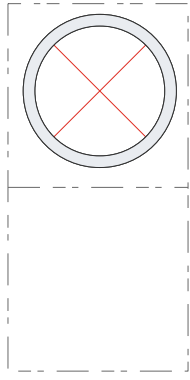
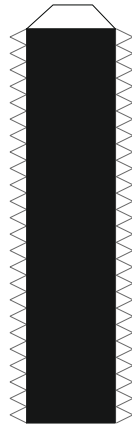
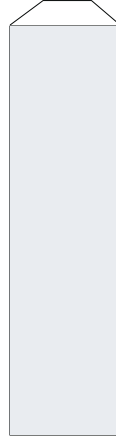
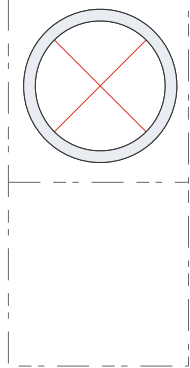

Podlepit na tl.0,5mm

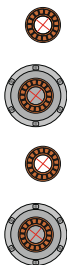

Podlepit na tl.0,3mm

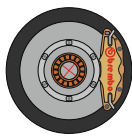
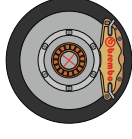

Brzdové třmeny použitelné u jiného vozu

1 : 18

Zadní kola